

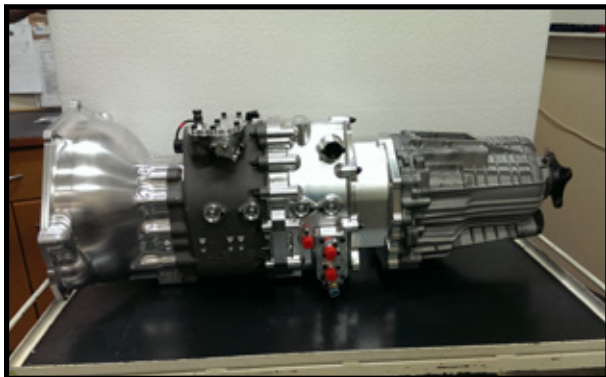

ST6-IR32 SERIES TRANSMISSION



APPLICATION

6 Speed Sequential Inline Transmission for Nissan R32GTR, R33GTR, Steaga RS4, R32+R33GTS4 4WD

TECHNICAL DETAILS

Cast LM25 aluminium housings heat treatment to T6 condition & stainless shot blasted

Compact, lightweight design

Innovative design allows very low engine mounting

Drop gear option for fast, economical gear changes

Internal oil pump and lubrication/cooling system

Inspection ports allow visual check of gear and dog wear

Rod and cable shift activation - Paddle Shift Option Available

Gears profile ground after heat treatment

All gears shot peened and isotropically finished

Heavy duty constant mesh reverse gear

Exceptionally short shift event times

Straight-cut drive gears and use of roller bearing internals to minimise power loss

High input, high output, front located drop gears

Custom input shafts and bell housing available

Weights 56 kgs

May require some modification to floor pan of vehicle

Trans will also fit vehicles with pull-type clutch when fitted with a push type clutch conversion

Additional driveline components and accessory mount options available upon request

Includes Bellhousing, crossmember mount, push type slave cylinder, rear housing/shaft to accept OEM transfer case

OPTIONS

Shifter

Transfer Case Spool



24 Wiltshire Lane, Delacombe
Victoria, Australia, 3356

Phone: +61 3 5335 8022

Fax: +61 3 5335 8366

sales@albins.com.au

www.albinsgear.com.au

**"SHIFT TO
A NEW LEVEL"**

ALBINS

Albins Performance

Transmissions is an Australian Proprietary Limited Company that specialises in the design and manufacture of drivetrain components. Our capabilities include the ability to produce; individual gears, axles, drive flanges and ring and pinions right through to complete unit, sequential shift transmissions.



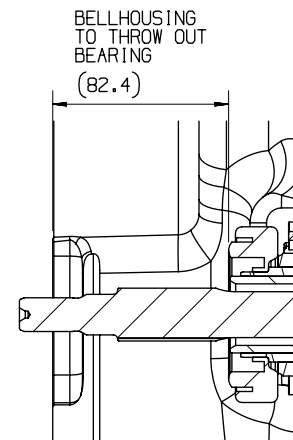
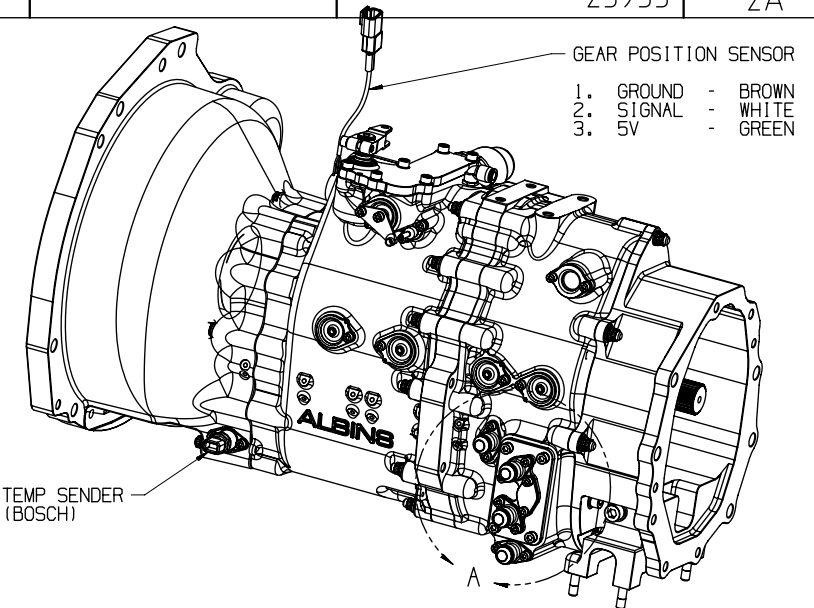
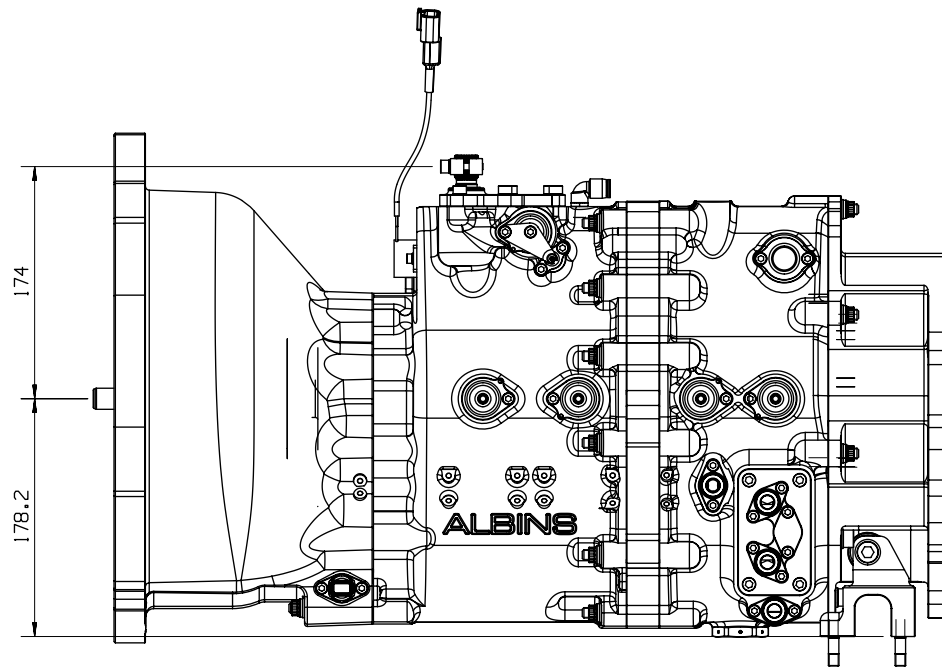
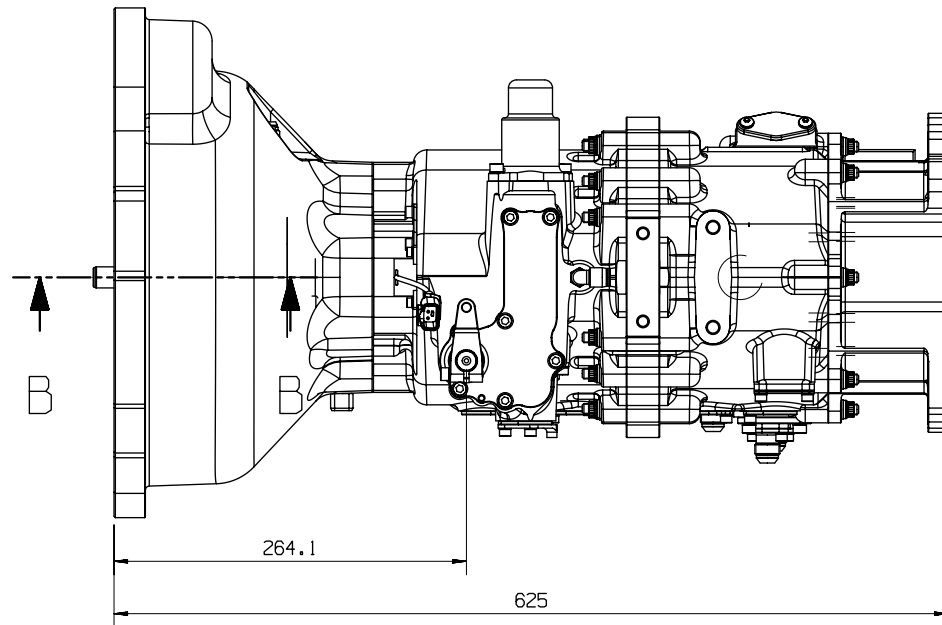

SECTION B-B

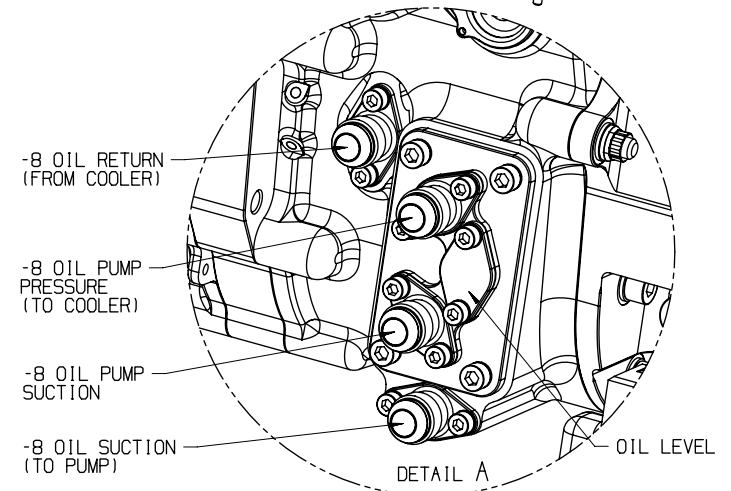

To fill the transmission with oil, remove the -8 line connected to the oil pump outlet fitting. Attach the oil drum line to this hose so oil is pumped through the cooler lines prior to filling the transmission. Remove the fitting from the side of the transmission and fill to the lower portion of this hole while the vehicle is on a level surface. By filling the transmission in this way oil is pumped through all of the lines and then into the transmission, this allows all of the lines to be bled. Optimal operating level is achieved without running the transmission.